

 Spa Electrics®

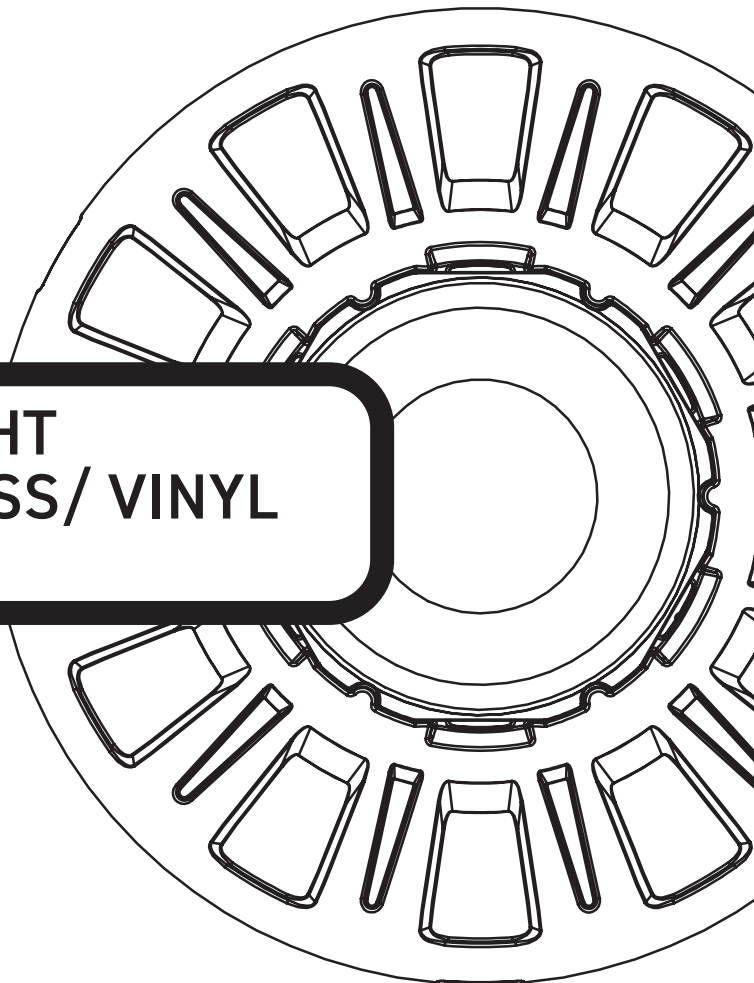

# TITAN



## TITAN LIGHT FIBREGLASS/ VINYL INSTALL

# T1

INSTALLATION & OWNER'S MANUAL

# CONTENTS

READ THIS FIRST	3
TOOLS REQUIRED	4
INCLUDED PARTS	5
FINISHED INSTALLATION	6
INSTALLATION	8
RIM & THREADED SLEEVE REMOVAL	13
RIM & THREADED SLEEVE INSTALL	14
WINTERIZATION	16
KEY DIMENSIONS	21
TROUBLESHOOTING	22
ELECTRICAL GROUNDING	23
FCC COMPLIANCE STATEMENT	23

## IMPORTANT



A **12V AC** TRANSFORMER MUST BE INSTALLED.  
DC POWER SUPPLIES ARE NOT COMPATIBLE.

## NOTE



FRESH WATER USE ONLY  
NOT INTENDED FOR OPERATION OUT OF WATER

# READ THIS FIRST

Congratulations on your purchase of a Spa Electrics **Titan T1** Series Pool Light. This light has been designed in conjunction with leading pool professionals across Canada and manufactured solely in Australia.

**For safe and proper installation, please read this manual in full before commencing installation and use only the parts (screws, plugs, sealant etc) as provided.**

**For operating instructions, please refer to the MULTI PLUS Installation & User Guide.**

## **BEFORE YOU START:**

- Cables can be shortened to suit individual installation requirements. Spa Electrics recommends all cabling is protected by conduit and that a junction box (or similar) is incorporated into pool cabling design to avoid siphoning.
- Ensure that the lighting system is installed by a qualified person (e.g. registered pool builder and/or licensed electrician), in accordance with local, state and national regulations.
- For safe and proper installation, ensure that only those parts supplied with the system are used.
- Maximum installation depth for the **Titan T1** light is 20" below water line (to top of light).
- The **Titan T1** light must be correctly installed in or on the wall of the pool with the top of the lens no less than **4"** below the nominal water level.
- All lights should be mounted in a location that is easily accessible without the need for entering or lowering the pool water.

## **CLEANING:**

- Only use warm water and a soft brush or cloth to clean **Titan T1** lights. **DO NOT** use detergents or spirits as this can damage the light and void your warranty.

## **USE OF PRODUCT:**

- **DO NOT** operate light unless completely submerged in water.
- Operating the light for at least 15 minutes every week is advised (unless removed and stored safely for winter months).
- **Titan T1** lights are suited for both domestic and commercial installations and can be operated continuously (24/7) if required.
- Temperature range for installation, operation and servicing: +32°F ~ +104°F (0°C ~ +40°C)

# TOOLS REQUIRED

✓ Draw wire

✓ PVC Cement - Medium Body

✓ 1 ½" Threaded Bulkhead Fitting (for Vinyl or Fibreglass)

## IMPORTANT NOTES



- The use of power tools during installation is **not** recommended as these devices can cause faults and damage to light components.
- All installation steps should be carried out with manual tools only.
- The enclosed images are for illustrative purposes only. Appearances of parts and assemblies may vary from the enclosed illustrations
- Please contact Spa Electrics or contact us below if you have any questions regarding the correct installation of this product.

## PRODUCT SUPPORT AND INFORMATION

### CANADA

#### Select Pool Products

Tel: 1-855-881-0889

Email: [info@selectpoolproducts.ca](mailto:info@selectpoolproducts.ca)

[www.selectpoolproducts.ca](http://www.selectpoolproducts.ca)

### INTERNATIONAL

#### Spa Electrics Pty Ltd

[www.spaelectrics.ca](http://www.spaelectrics.ca)

# INCLUDED PARTS

## CABLE ASSEMBLY (P/N: T1 18AWG 100/150)

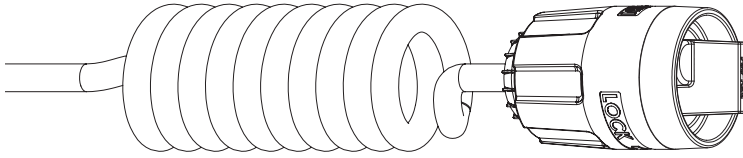

**CABLE**  
with coiled section

**PLUG ASSEMBLY**  
with PLUG COVER attached

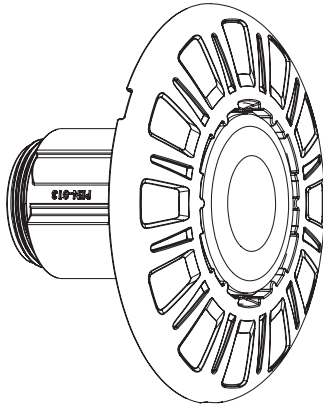

**LIGHT ASSEMBLY**  
with RIM (P/N: T1FV 004) &  
THREADED SLEEVE (P/N: T1 017)  
attached

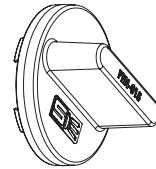

**LIGHT INSTALLATION  
TOOL**  
(P/N: T1 016)

## REQUIRED PART (NOT INCLUDED)



### **UL LISTED ISOLATING LOW VOLTAGE POWER SUPPLY, EVALUATED FOR SWIMMING POOL USE.**

Installed as per current NEC wiring rules. 12~14v AC output. Minimum 8W per Retro Series Pool Light. Spa Electrics recommends "LVX" safety transformers for use with Retro Universal lights

# FINISHED INSTALLATION - TYPE A

Depending on your installation requirements, conduits may run to a common junction box or return directly to the power supply. In either case, it is imperative that the conduit extends above the water level of the pool at some point in order to prevent siphoning.

**The example on this page shows an installation where a Junction Box is NOT required.**

**NOTE:** Conduit should contain draw-wire to allow easy installation of power cable.

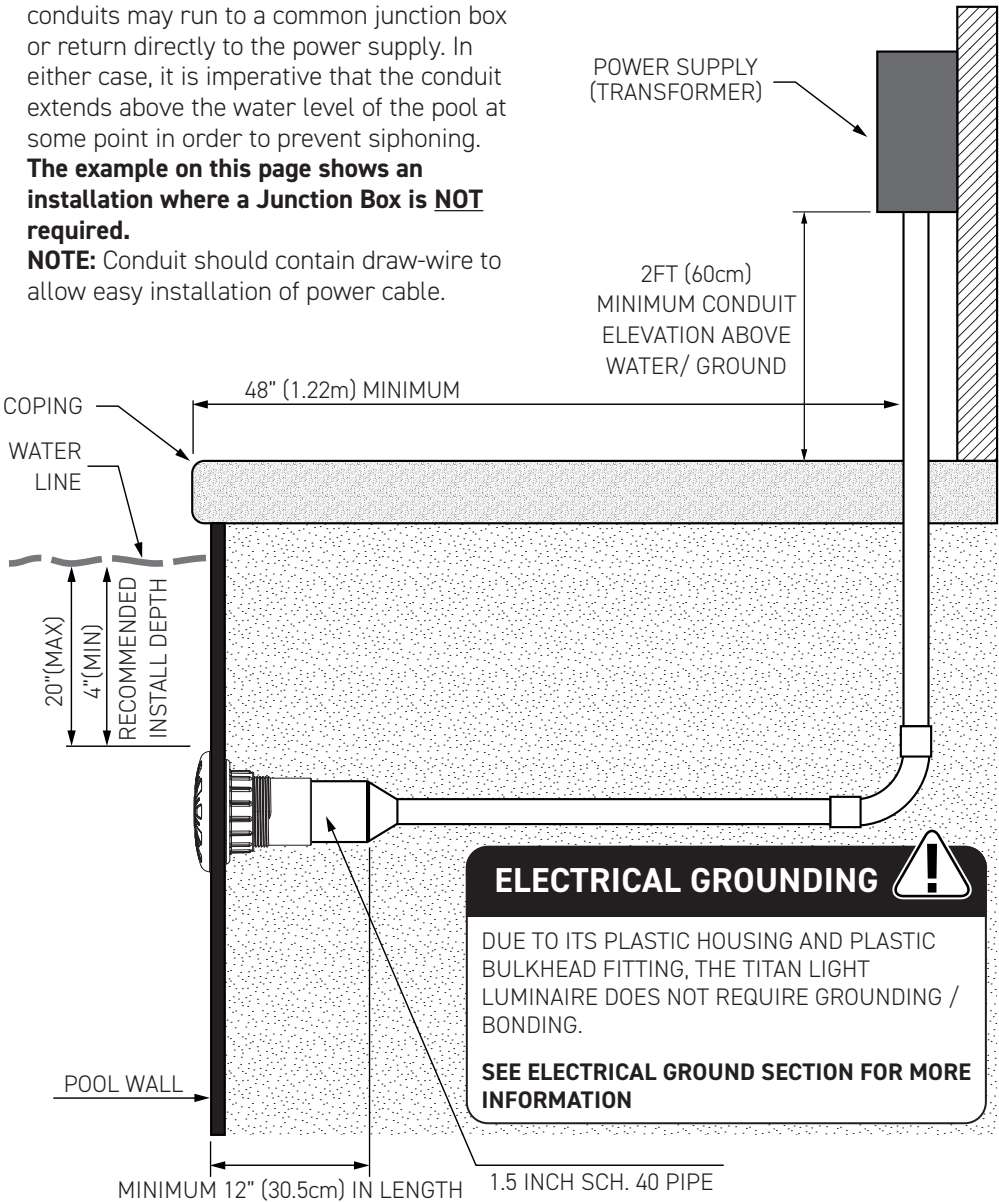

## ELECTRICAL GROUNDING

DUE TO ITS PLASTIC HOUSING AND PLASTIC BULKHEAD FITTING, THE TITAN LIGHT LUMINAIRE DOES NOT REQUIRE GROUNDING / BONDING.

**SEE ELECTRICAL GROUND SECTION FOR MORE INFORMATION**

**POOL CROSS SECTION SHOWN FOR REFERENCE ONLY**

# FINISHED INSTALLATION - TYPE B

Depending on your installation requirements, conduits may run to a common junction box or return directly to the power supply. In either case, it is imperative that the conduit extends above the water level of the pool at some point in order to prevent siphoning.

**The example on this page shows an installation where a Junction Box is required.**

**NOTE:** Conduit should contain draw-wire to allow easy installation of power cable.

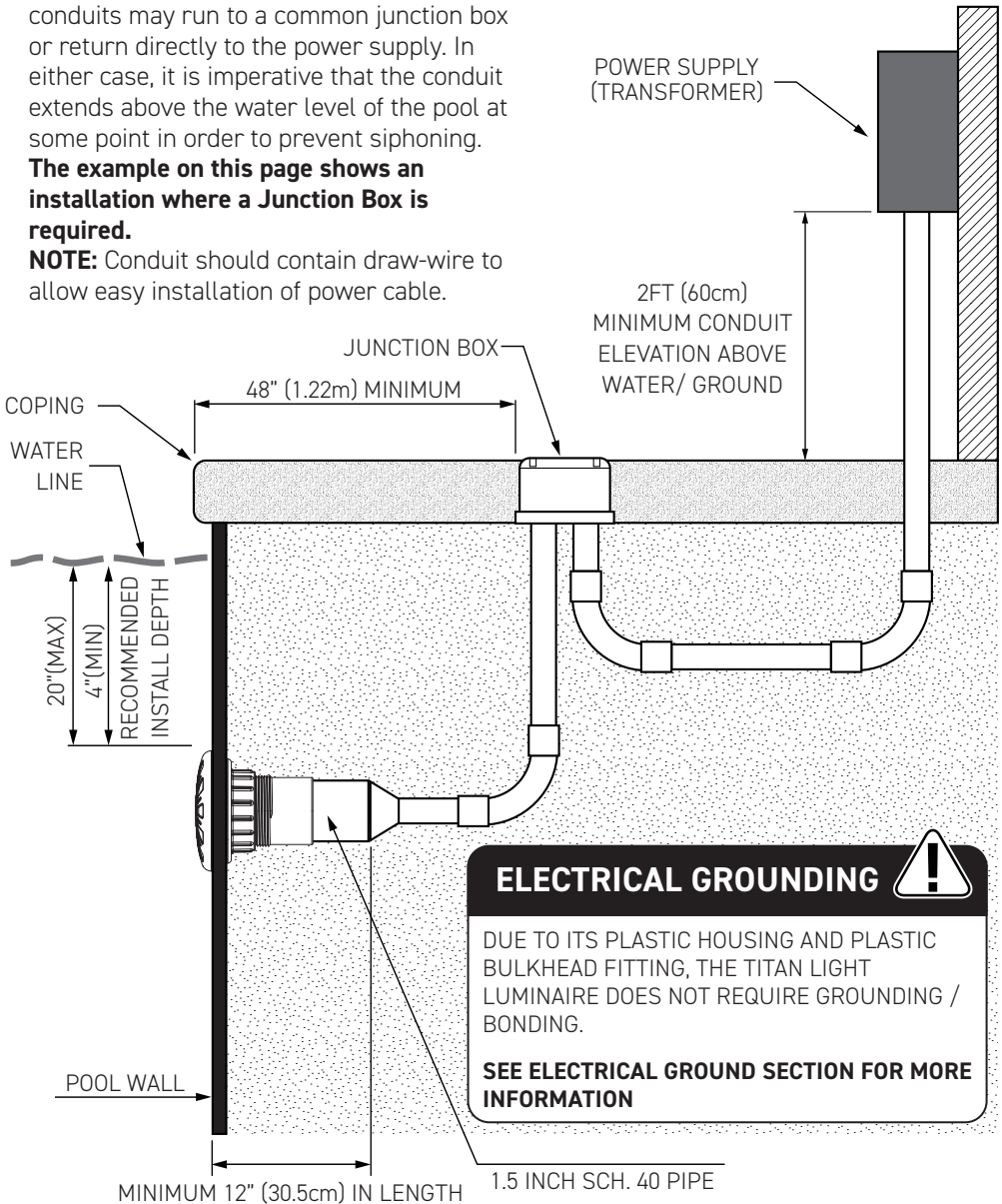

**POOL CROSS SECTION SHOWN FOR REFERENCE ONLY**

# INSTALLATION

THIS SPA ELECTRICS TITAN T1 LIGHT IS DESIGNED TO BE INSTALLED IN A 1 ½" THREADED BULKHEAD FITTING IN EITHER A FIBREGLOSS OR VINYL POOL.  
SEE THE FOLLOWING ILLUSTRATIONS OF EXAMPLES FOR REFERENCE ONLY.

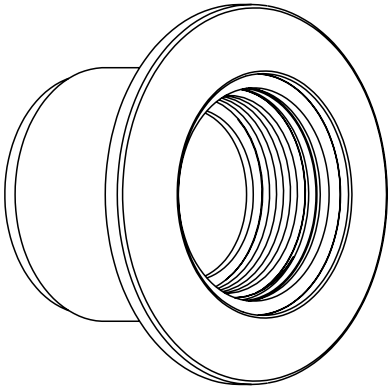

**FIBREGLOSS**

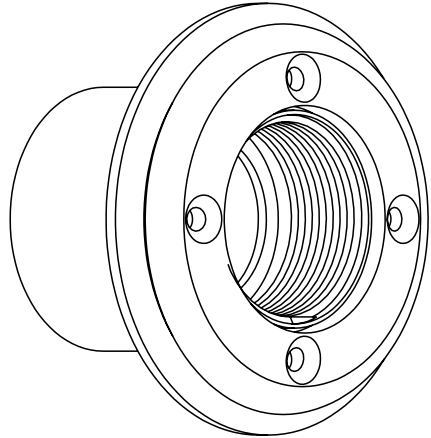

**VINYL**

THE FOLLOWING INSTALLATION INSTRUCTIONS SHOW AN EXAMPLE OF A FIBREGLOSS BULKHEAD.

## 1 FEED CABLE

FEED CABLE WITH PLUG ASSEMBLY AND PLUG COVER THROUGH THE BULKHEAD AND PIPE.

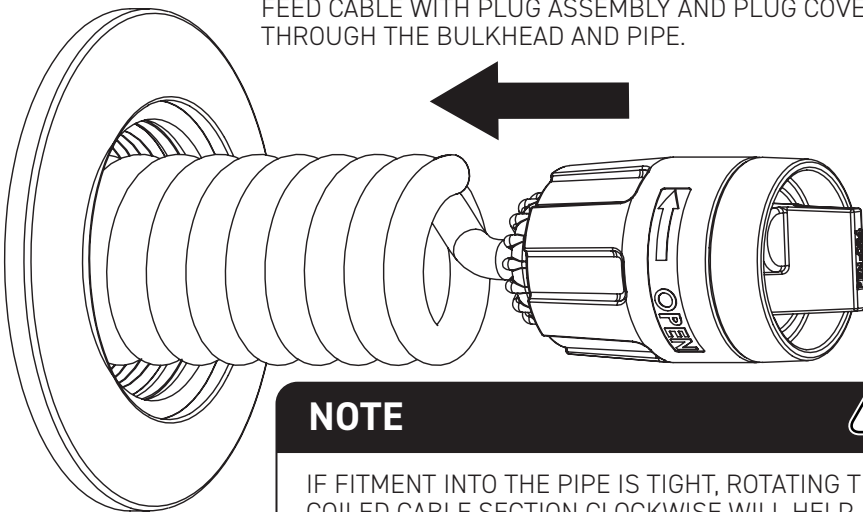

### NOTE



IF FITMENT INTO THE PIPE IS TIGHT, ROTATING THE COILED CABLE SECTION CLOCKWISE WILL HELP PROVIDE CLEARANCE TO THE PIPE.



## 2

### REMOVE PLUG COVER

WHEN READY TO ATTACH THE LIGHT ASSEMBLY, REMOVE THE PLUG **COVER** BY TWISTING THE **COLLAR** ANTI-CLOCKWISE A FEW TIMES UNTIL IT IS FREE SPINNING.

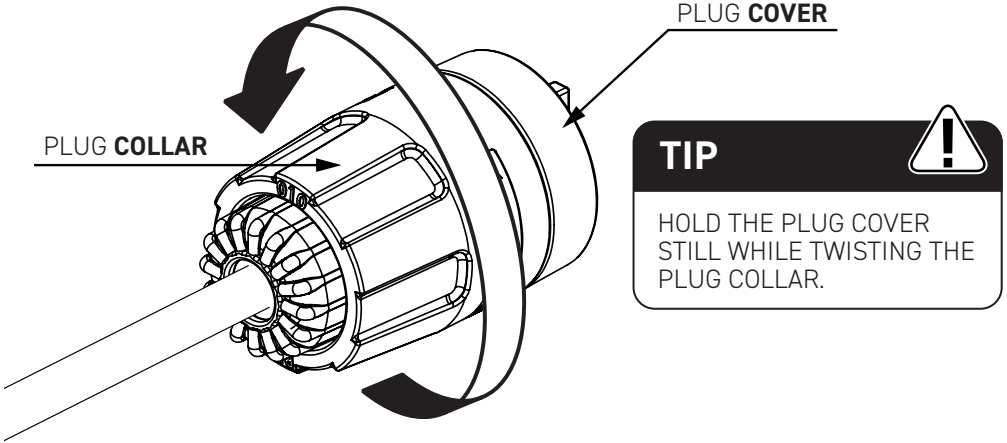

## 3

### REMOVE PLUG COVER

DISCONNECT PLUG COVER FROM PLUG BY PULLING APART.

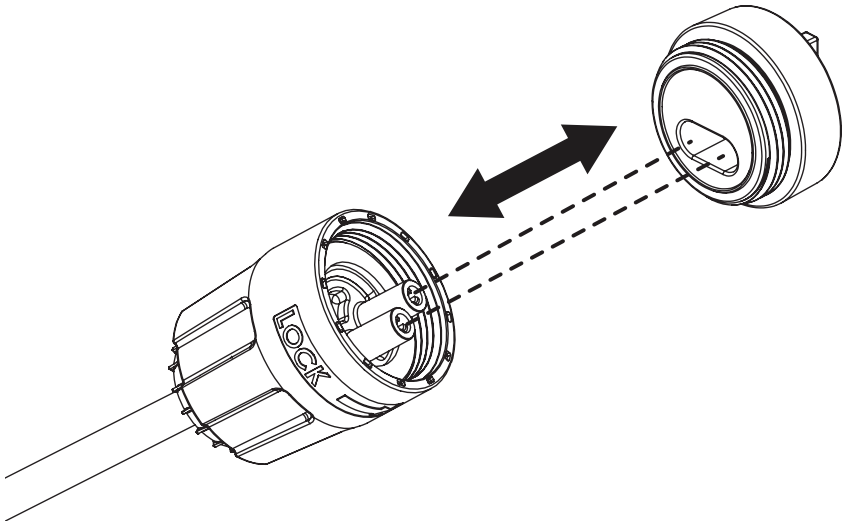

# 4

## CONNECT THE TERMINALS

ALIGN THE TERMINAL PINS ON THE PLUG AND BACK OF THE LIGHT ASSEMBLY AND FIRMLY CONNECT TOGETHER.

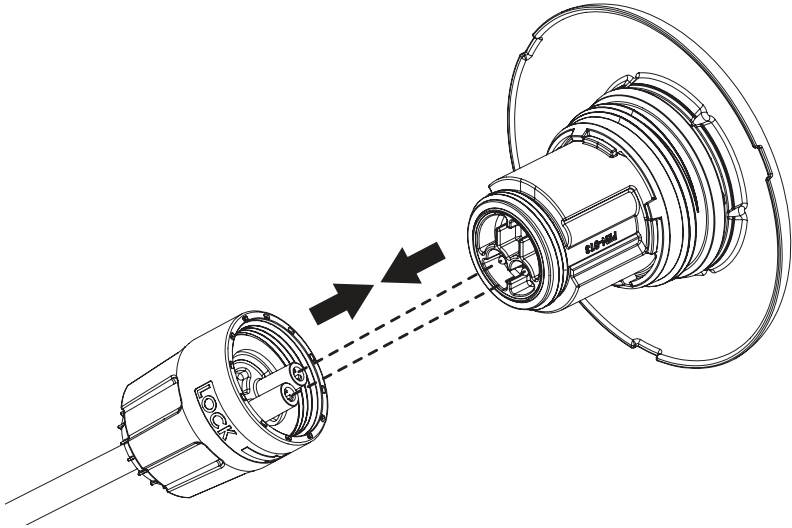

# 5

## FASTEN PLUG TO LIGHT

TO LOCK INTO PLACE:  
TWIST COLLAR CLOCKWISE A FEW TIMES UNTIL IT'S HAND TIGHT.

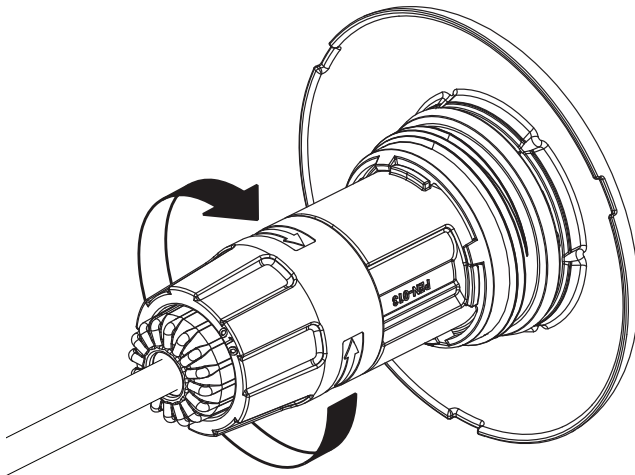

# 6

## ROTATE LIGHT CLOCKWISE

JUST BEFORE INSERTING THE LIGHT INTO THE BULKHEAD, ROTATE THE LIGHT CLOCKWISE A COUPLE TURNS.

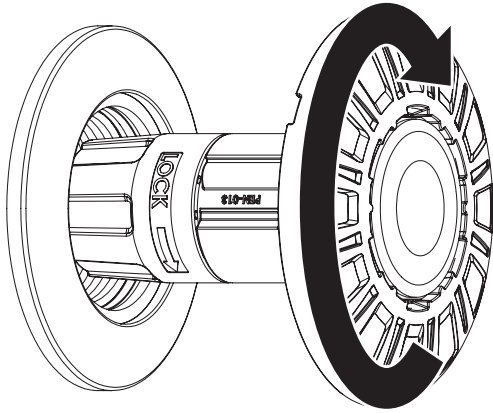

# 7

## INSERT LIGHT INTO BULKHEAD FITTING

INSERT THE LIGHT ASSEMBLY INTO THE BULKHEAD FITTING.

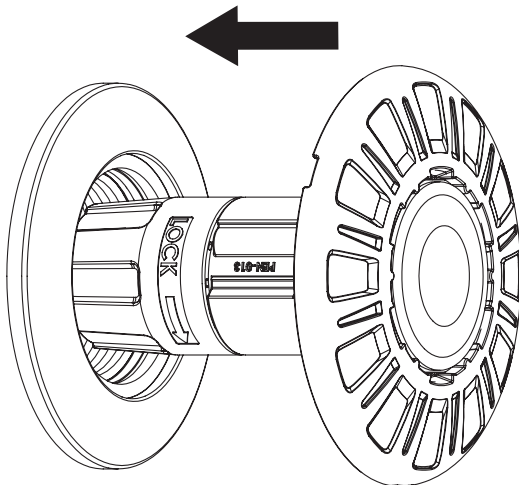

# 8

## THREAD LIGHT INTO BULKHEAD FITTING

1. INSERT THE LIGHT INSTALLATION TOOL INTO THE FRONT OF THE LIGHT ASSEMBLY, ALIGNING THE TEETH ON THE TOOL WITH THE SLOTS ON THE RIM.
2. TWIST THE LIGHT ASSEMBLY WITH THE TOOL CLOCKWISE INTO THE BULKHEAD FITTING UNTIL FIRMLY HAND TIGHT.

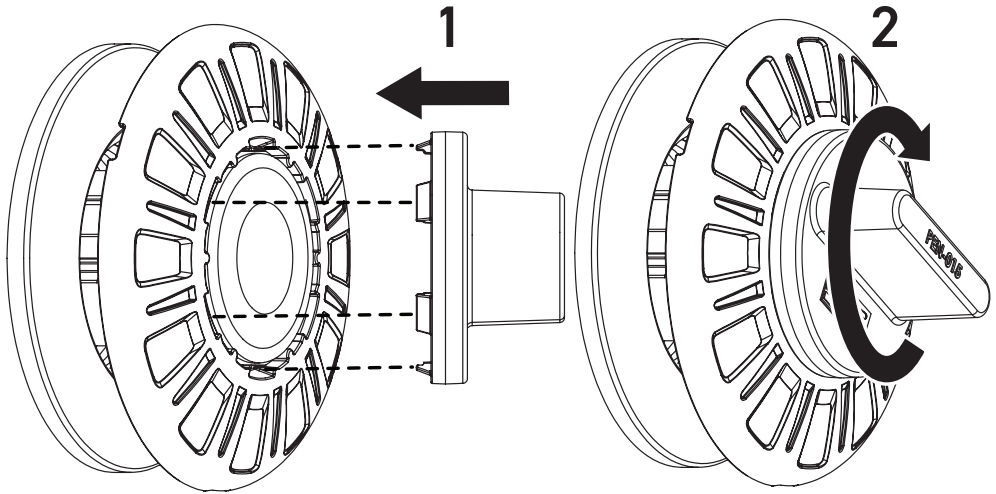

# RIM & THREADED SLEEVE REMOVAL

## 1 REMOVE THREADED SLEEVE

1. INSERT THE LIGHT INSTALLATION TOOL INTO THE FRONT OF THE LIGHT ASSEMBLY. ALIGNING THE TEETH ON THE TOOL WITH THE SLOTS ON THE RIM.
2. HOLD THE LOCKING TOOL SO THE LIGHT ASSEMBLY DOES NOT ROTATE WHEN REMOVING THE THREADED SLEEVE IN STEP 3 BELOW.

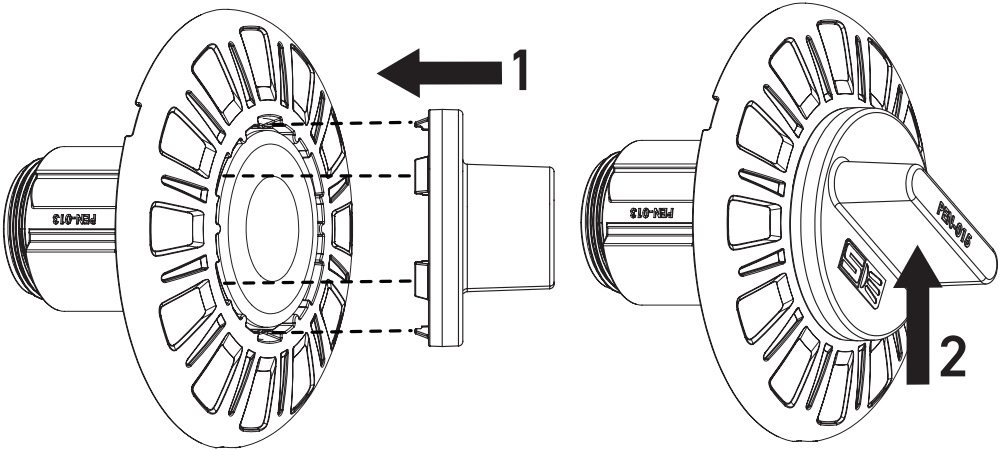

3. TWIST THE THREADED SLEEVE ANTI-CLOCKWISE TO UNLOCK IT.
4. THEN SLIDE THE SLEEVE OFF THE LIGHT ASSEMBLY.

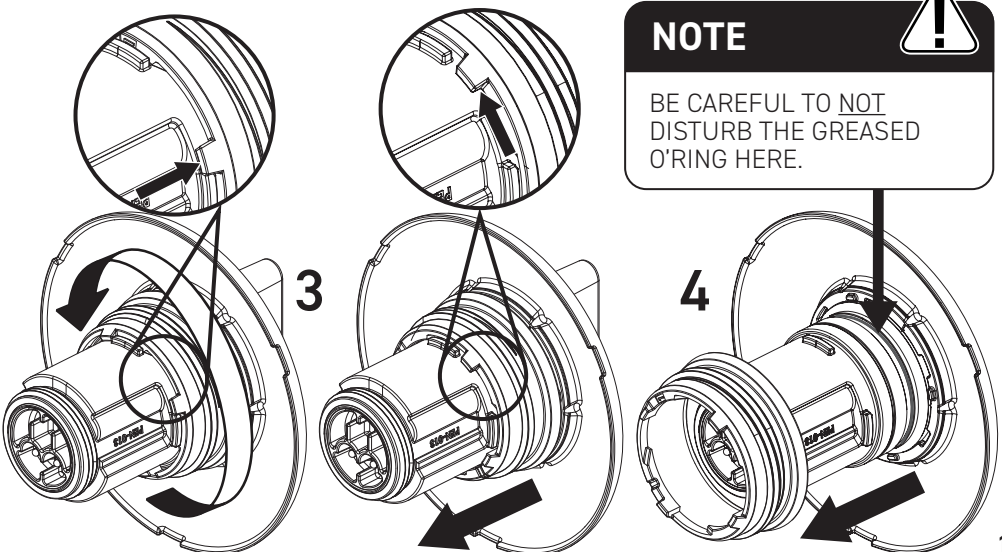

## 2

## REMOVE RIM

WITH THE SLEEVE REMOVED, THE RIM CAN BE CLIPPED OFF THE LIGHT ASSEMBLY. REMOVE THE RIM BY HAND ONLY.

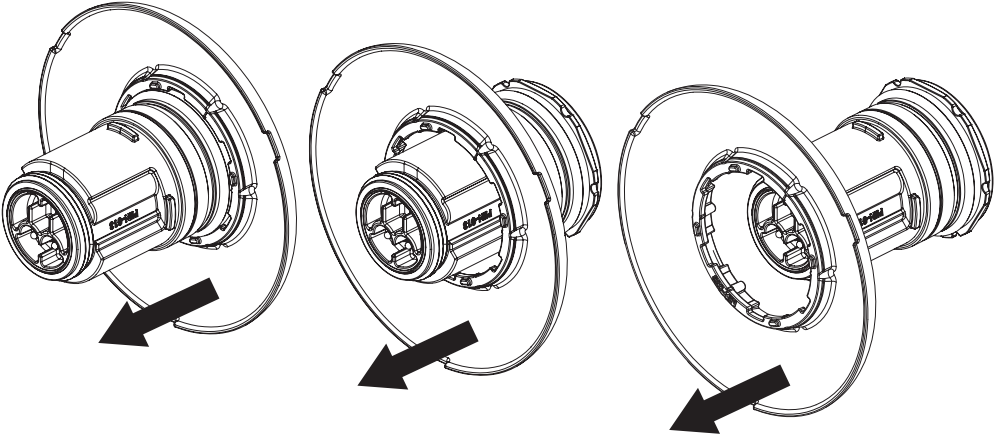

## RIM & THREADED SLEEVE INSTALL

## 1

## ATTACH RIM

ALIGN THE RIM AND SLIDE IT OVER THE LIGHT ASSEMBLY UNTIL IT SNAPS INTO PLACE AND IS FULLY SEATED AS INDICATED. DO THIS BY HAND ONLY.

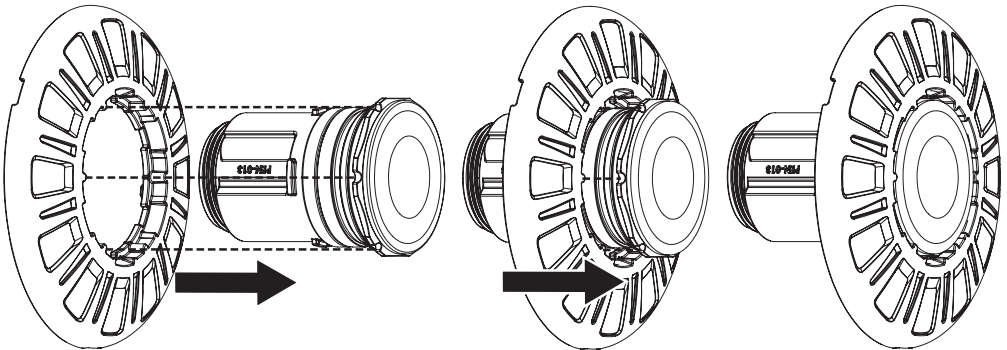

**NOTE THE INDICATED ALIGNMENT POINTS ON THE RIM AND LIGHT ASSEMBLY.**

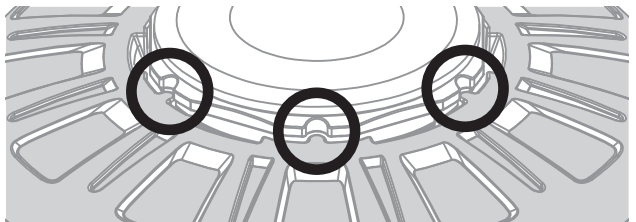

## 2

## ATTACH THREADED SLEEVE

1. INSERT THE LIGHT INSTALLATION TOOL INTO THE FRONT OF THE LIGHT ASSEMBLY. ALIGNING THE TEETH ON THE TOOL WITH THE SLOTS ON THE RIM.
2. HOLD THE LOCKING TOOL SO THE LIGHT ASSEMBLY DOES NOT ROTATE WHEN ATTACHING THE THREADED SLEEVE IN STEP 4 BELOW.

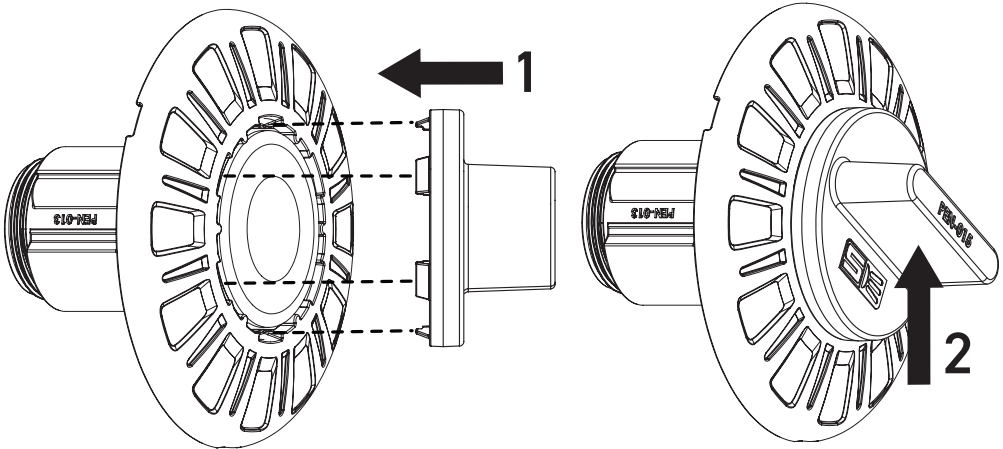

3. TWIST THE THREADED SLEEVE CLOCKWISE TO LOCK IT. NOTE THE POSITION OF THE INDICATED TAB.
4. SLIDE THE THREADED SLEEVE ONTO THE LIGHT ASSEMBLY.

### NOTE



BE CAREFUL TO NOT DISTURB THE GREASED O'RING HERE.

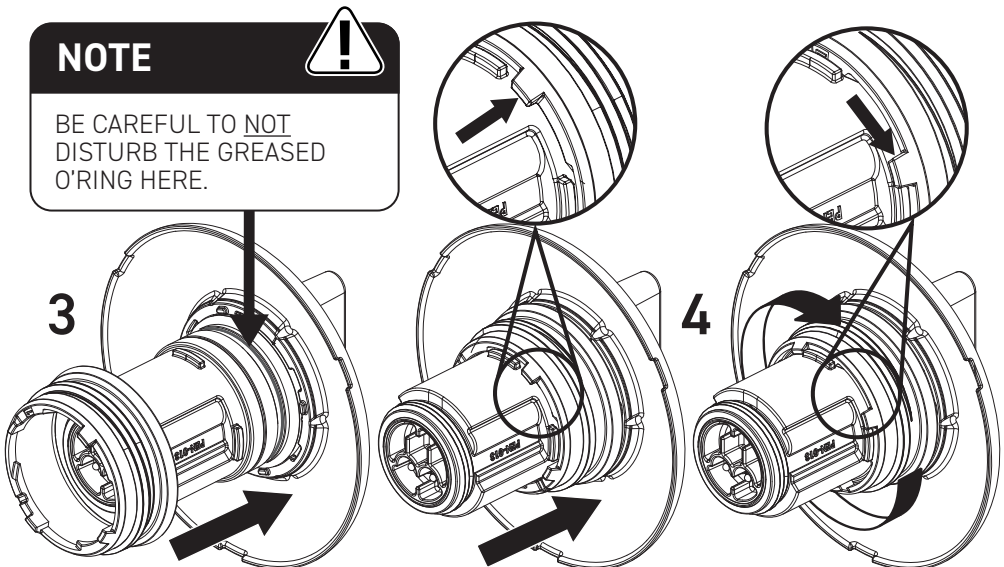

# WINTERIZATION

## 1 UN-THREAD LIGHT FROM BULKHEAD

1. INSERT THE LIGHT INSTALLATION TOOL INTO THE FRONT OF THE LIGHT ASSEMBLY, ALIGNING THE TEETH ON THE TOOL WITH THE SLOTS ON THE RIM.
2. TWIST THE LIGHT ASSEMBLY WITH THE TOOL ANTI-CLOCKWISE TO UN-THREAD FROM THE BULKHEAD FITTING.

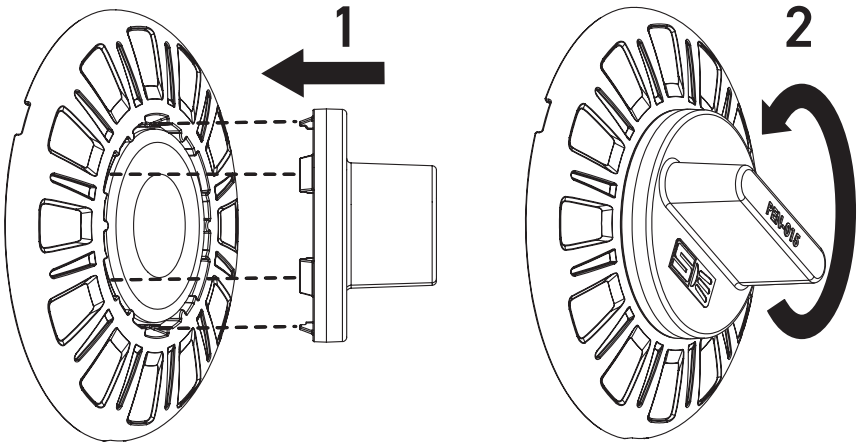

## 2 PULL LIGHT OUT OF BULKHEAD FITTING

PULL LIGHT ASSEMBLY WITH PLUG ATTACHED OUT OF THE BULKHEAD FITTING.

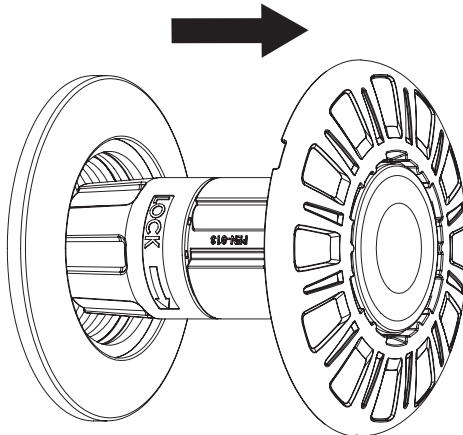



### 3

## REMOVE PLUG COLLAR FROM LIGHT

UNSCREW PLUG COLLAR ANTI-CLOCKWISE UNTIL IT IS FREE SPINNING.

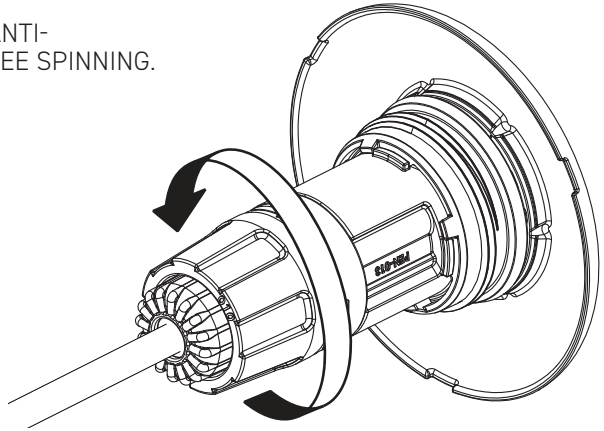

### IMPORTANT NOTES



CABLE SHOULD BE SECURED ABOVE WATER AND WEATHER PROTECTED WHILE LIGHT IS DETACHED.

### 4

## REMOVE PLUG FROM LIGHT

DISCONNECT LIGHT ASSEMBLY FROM PLUG BY PULLING APART.

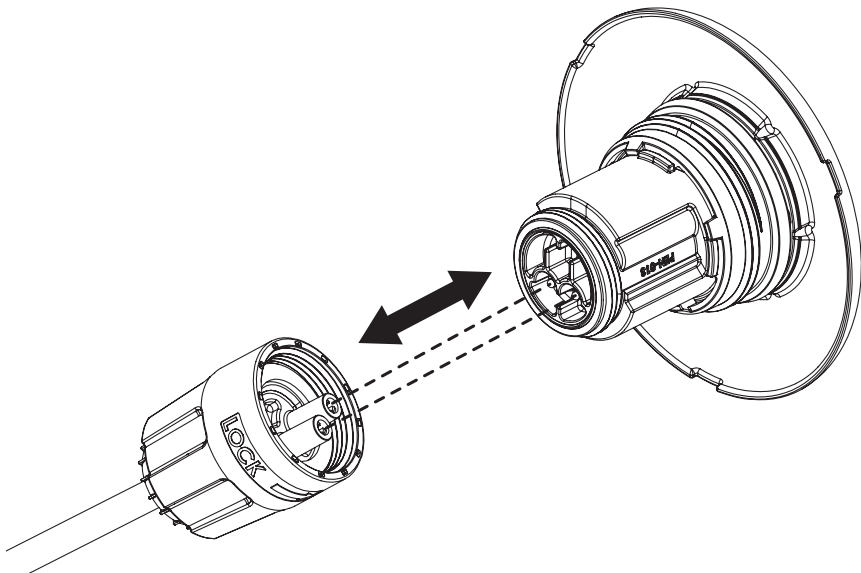

# 5

## ATTACH PLUG COVER TO PLUG

ALIGN THE TERMINAL PINS ON THE PLUG WITH THE SLOT ON THE PLUG COVER AND CONNECT TOGETHER.

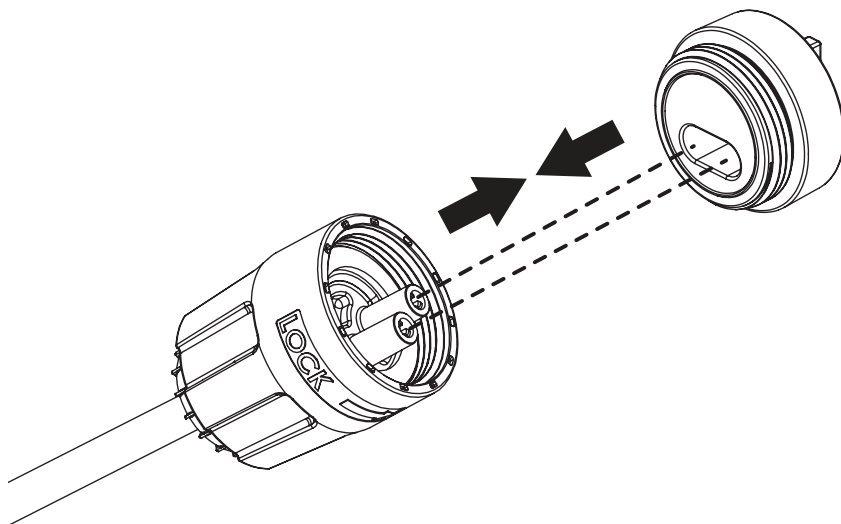

# 6

## FASTEN PLUG COVER

TO LOCK INTO PLACE:  
TWIST THE PLUG **COLLAR** CLOCKWISE A FEW TIMES UNTIL IT'S HAND TIGHT.

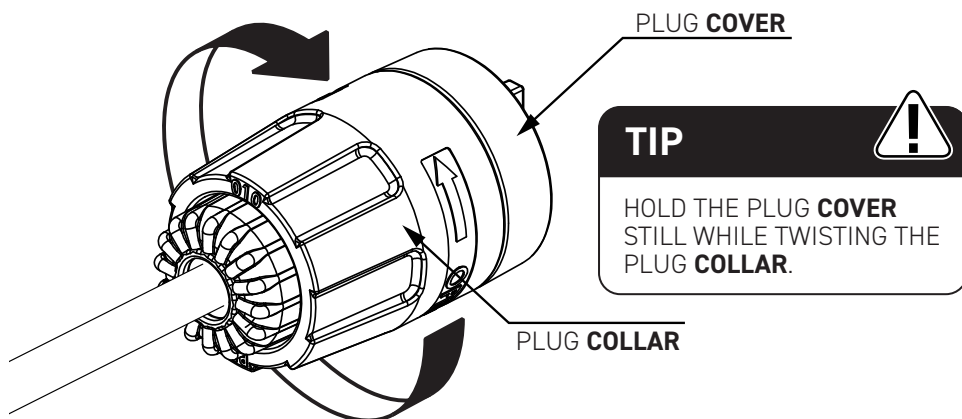

# 7

## REMOVE WATER FROM PIPE

REMOVE THE REMAINING WATER FROM THE PIPING, THIS MAY INVOLVE BLOWING OUT WITH COMPRESSED AIR.

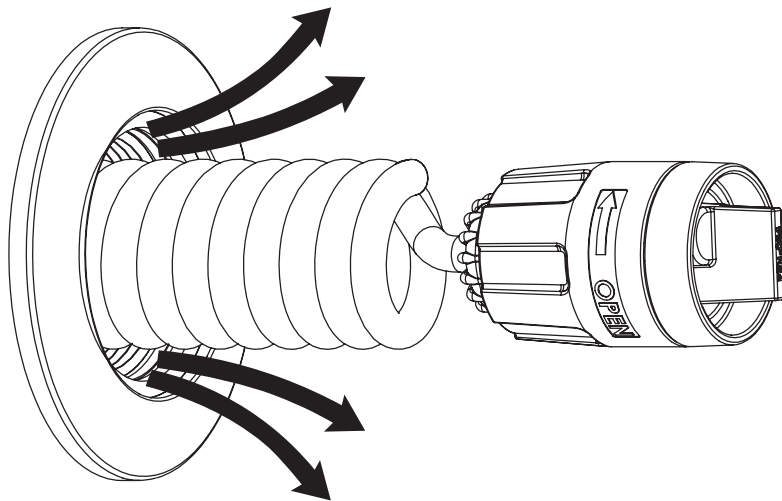

# 8

## STORE CABLE

STORE CABLE BACK INTO THE PIPING.

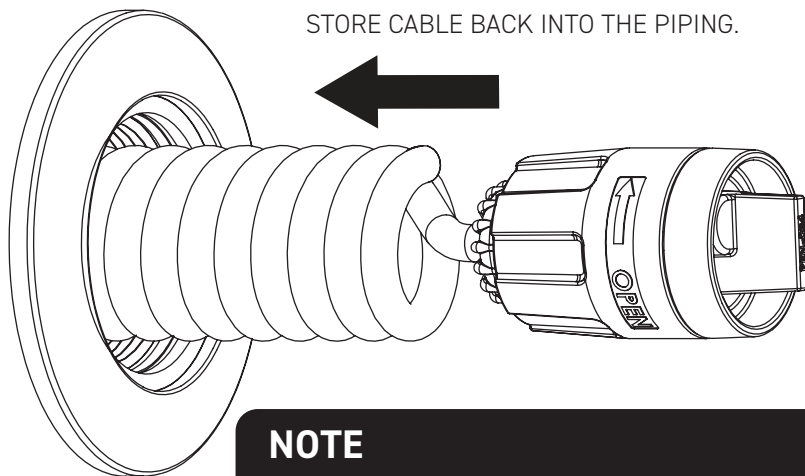

### NOTE



IF FITMENT INTO THE PIPE IS TIGHT, ROTATING THE COILED CABLE SECTION CLOCKWISE WILL HELP PROVIDE CLEARANCE TO THE PIPE.

# 9

## SEAL PIPE OPENING

SELECT FROM COMMONLY AVAILABLE WINTERIZATION FITTINGS TO SEAL OFF THE BULKHEAD FITTING, IT IS IMPORTANT TO ENSURE THEY ARE APPROPRIATELY SELECTED AND INSTALLED TO ACHIEVE A WATER TIGHT SEAL.

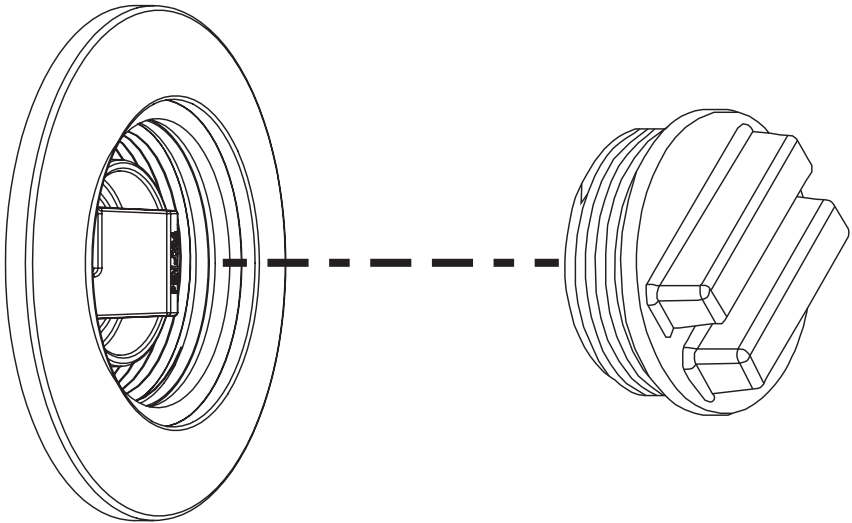

### IMPORTANT NOTE



IMAGE OF SEALED FITTING SHOWN FOR REFERENCE ONLY. ENSURE THE CORRECT TYPE IS SELECTED TO SEAL OFF BULKHEAD FITTING.

# KEY DIMENSIONS

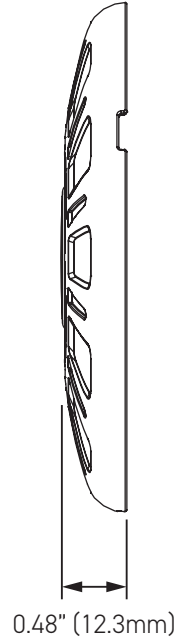
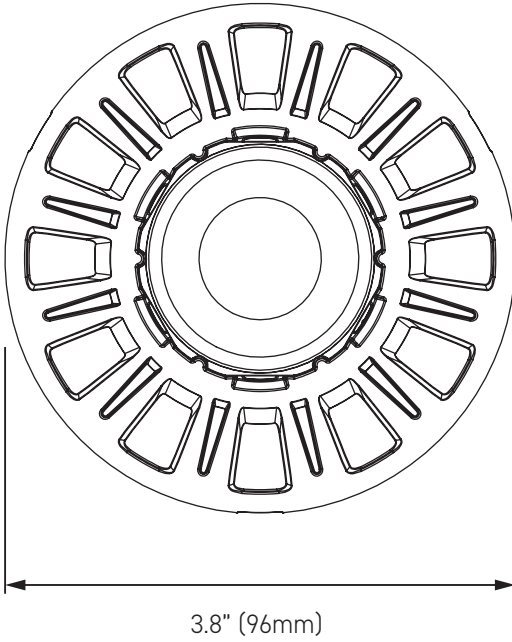

# TROUBLESHOOTING

ISSUE	REASON	ACTION
Light returns to WHITE colour during manual colour change	Light synchronization process has been triggered	Refer to MULTI PLUS Installation & User Guide
Light flashes 2 times (RED)	Light over heating.	Check light is fully submerged. Check vents are not obstructed
Light not operating (1)	Faulty connection to transformer	Ensure cable correctly connected to transformer terminals
Light not operating (2)	Mains power not connected	Check transformer is plugged in to GPO and switched on
Light not operating (3)	Damaged cable	Disconnect plug top and test voltage under load using multi-meter (ie. 20w 12v)
Light not operating (4)	Transformer not working	Check fuses & test transformer using multimeter under load (ie.15W 12V)
Light colours not synchronized	Incorrect operating mode selected.	Refer to MULTI PLUS setup procedure

**If these issues cannot be resolved with the above recommended actions, please contact your local Spa Electrics reseller or Spa Electrics directly.**

[www.spaelectrics.ca](http://www.spaelectrics.ca)

# ELECTRICAL GROUNDING

## Underwriters Laboratories (UL) Statement

Per the NEC, NFPA 70, Article 680.23 (B)(5), states that bonding shall not be required for luminaires that are listed for the application and have no non-current carrying metal parts. In addition, per Article 680.26 (B)(4), exception states that Listed low-voltage lighting systems with non-metallic forming shells shall not require bonding.

Therefore, luminaires with polymeric/non-current carrying metal parts are not required to be grounded / bonded.

## Manufacturers Statement

Spa Electrics **Retro Universal** luminaires with their plastic housing designs do not require grounding / bonding.

Spa Electrics **Retro Universal** lights have also been determined to comply with the applicable requirements for wet-niche, LED type Swimming Pool and Spa Luminaires.

# FCC COMPLIANCE STATEMENT

This device complies with part 15 of the FCC rules. Operation is subject to the following two (2) conditions:

1. This device may not cause harmful interference, and
2. This device must accept any interference received, including interference that may cause undesired operation.

**Note:** This equipment has been tested and found to comply with the limits for a Class B digital device, pursuant to part 15 of the FCC Rules. These limits are designed to provide reasonable protection against harmful interference in a residential installation. This equipment generates, uses and can radiate radio frequency energy and, if not installed and used in accordance with the instructions, may cause harmful interference to radio communications. However, there is no guarantee that interference will not occur in a particular installation. If this equipment does cause harmful interference to radio or television reception, which can be determined by turning the equipment off and on, the user is encouraged to try to correct the interference by one or more of the following measures:

- **Reorient or relocate the receiving antenna.**
- **Increase the separation between the equipment and receiver.**
- **Connect the equipment into an outlet on a circuit different to that to which the receiver is connected.**
- **Consult the dealer or an experienced radio / TV technician for help.**

**Do not make any changes or modifications to the equipment unless otherwise specified in the manual.**



## IMPORTANT NOTE

PLEASE STORE THIS MANUAL IN A SAFE PLACE  
FOR FUTURE REFERENCE



Proudly manufactured by

**Spa** Electrics



[www.spaelectrics.ca](http://www.spaelectrics.ca)

©COPYRIGHT 2025 SPA ELECTRICS INC.  
ALL RIGHTS RESERVED

CA 2025 01 31