

ARGON SERIES

CABLE INSTALLATION GUIDE

1: CABLE PREPARATION

STRIP POOL LIGHT CABLE TO SPECIFIED LENGTH.

NOTE
IF CABLE LENGTH ALLOWS, CUT CABLE BACK UNTIL FRESH COPPER APPEARS.

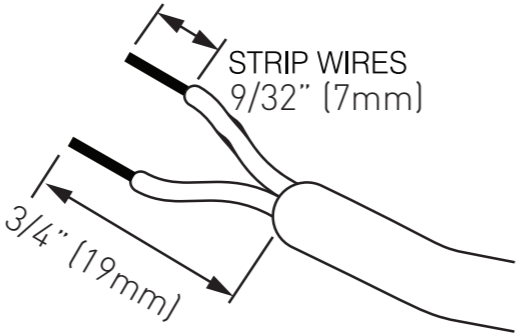

2: START ASSEMBLY OF CONNECTOR PLUG

1: FEED THE CONNECTOR COLLAR ONTO THE CABLE, THEN FEED THE GLAND NUT ONTO THE CABLE.

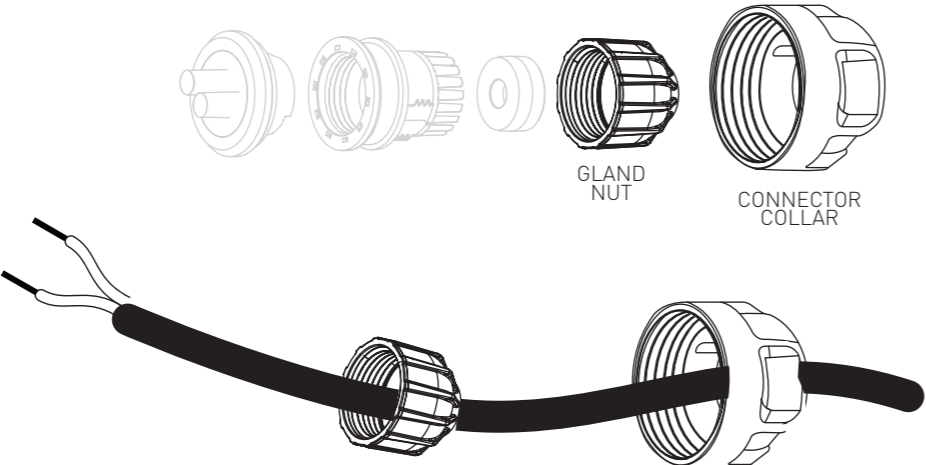

3: CHOOSE THE APPROPRIATE GLAND

SELECT THE CABLE GLAND THAT FITS THE EXISTING POWER CABLE WITHOUT BULGING.

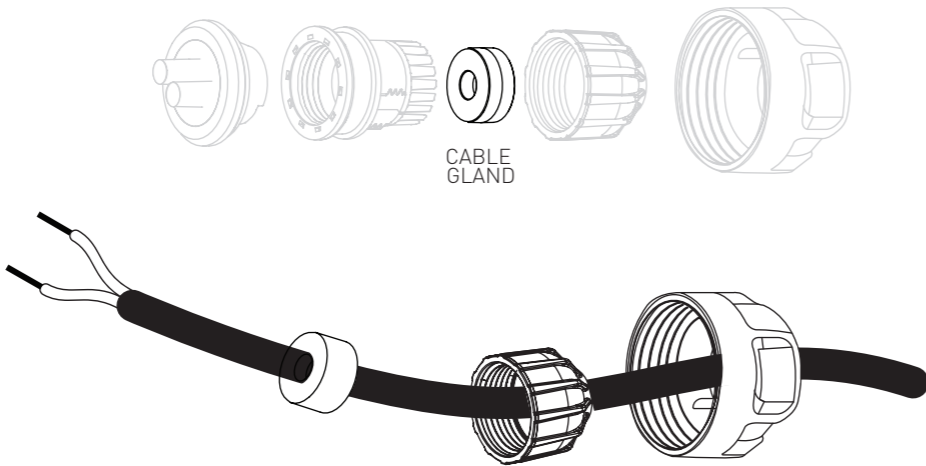

4: CONTINUE ASSEMBLY OF CONNECTOR PLUG

FEED THE CONNECTOR BARREL ONTO THE CABLE.

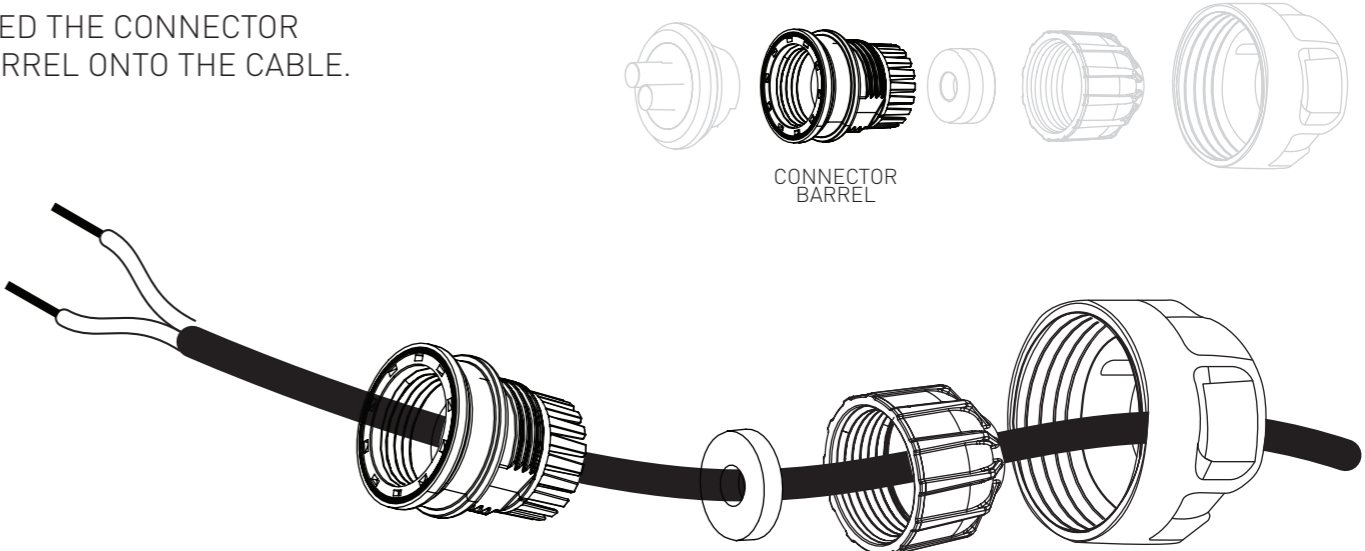

5: CONNECT THE SCREW TERMINAL END

1: FEED THE TWO STRIPPED CABLE ENDS THROUGH THE TWO HOLES IN THE BACK OF THE SCREW TERMINAL END.

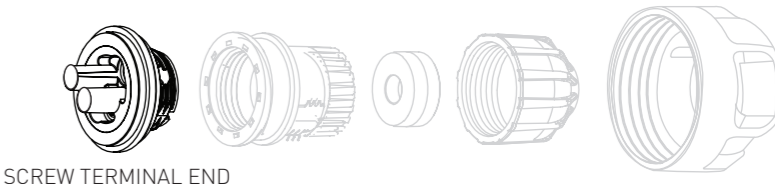

2: USE A FLAT BLADE SCREWDRIVER TO TIGHTEN THE FASTENERS ON EITHER SIDE OF THE SCREW TERMINAL.

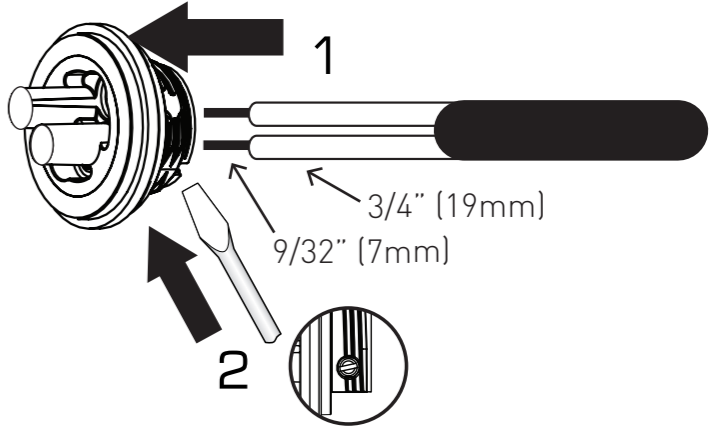

ARGON SERIES

CABLE INSTALLATION GUIDE

6: START ASSEMBLY OF CONNECTOR PLUG

- 1: CAREFULLY THREAD CONNECTOR BARREL ONTO SCREW TERMINAL AND TIGHTEN FIRMLY BY HAND.
- 2: SEAT CABLE GLAND ALL THE WAY INTO CONNECTOR (DO A VISUAL CHECK TO MAKE SURE A SEAL BETWEEN GLAND AND CABLE)
- 3: CAREFULLY THREAD GLAND NUT ONTO CONNECTOR BARREL AND TIGHTEN FIRMLY BY HAND.

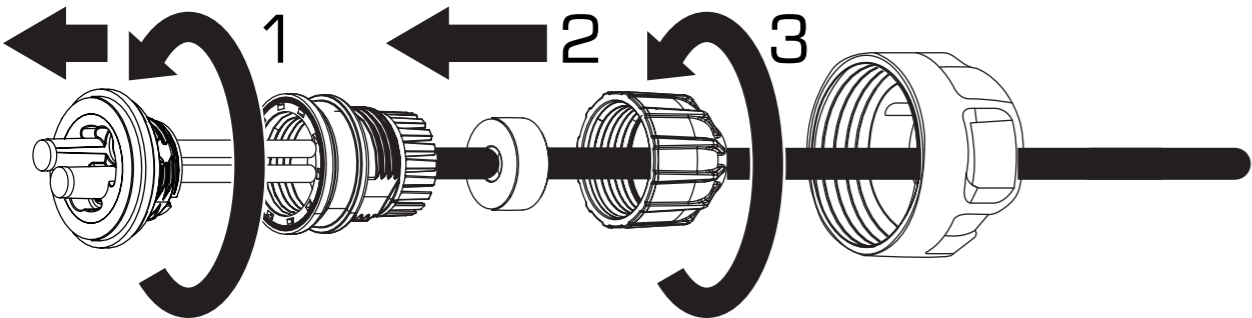
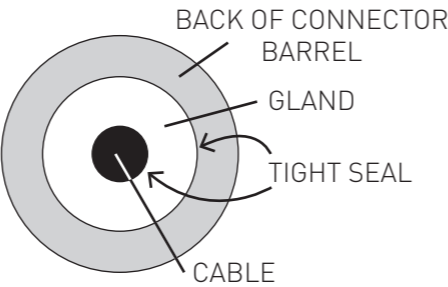

7: CONTINUE ASSEMBLY OF CONNECTOR PLUG

- 1: PUSH CONNECTOR COLLAR ALL THE WAY IN TO THE END UNTIL THERE ARE TWO DISTINCT "CLICKS". THE END WILL BE FREE TO ROTATE.

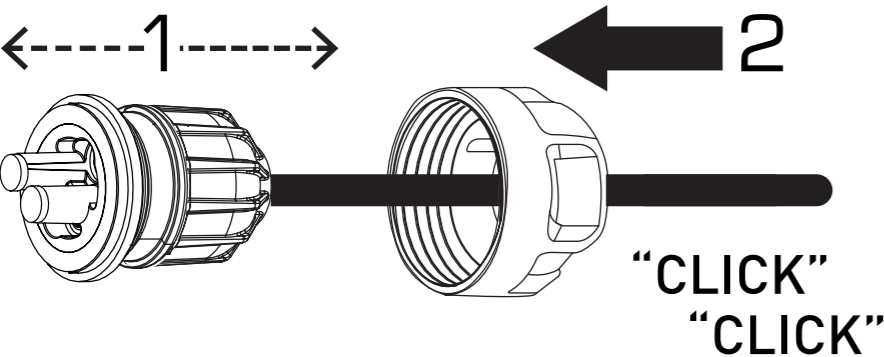

8: ADD LANOLIN

- 1: REMOVE 2 X FILLER SCREWS AND O-RING SEALS FROM SCREW TERMINAL PLUG.

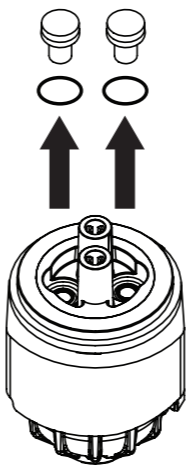

- 2: INJECT LANOLIN INTO LEFT FILLER HOLE UNTIL VISIBLE IN RIGHT FILLER HOLE.

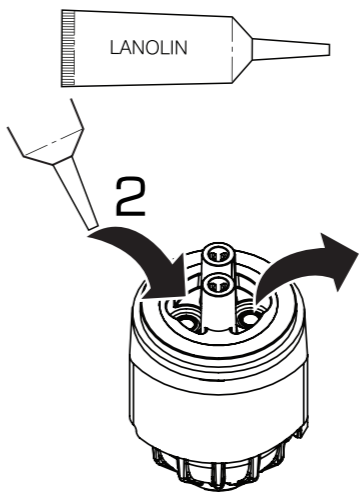

- 3: REPLACE THE O-RING SEALS AND 2 X FILLER SCREWS IN THE FILLER HOLES.

ENSURE NOT TO OVER TIGHTEN.

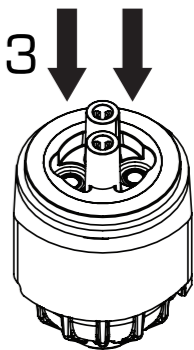

LANOLIN USE



GENTLY WARM LANOLIN BEFORE USE

NOTE



USE A TOWEL TO PROTECT POOL SURROUNDING

ASSEMBLED VIEW OF CONNECTOR PLUG.

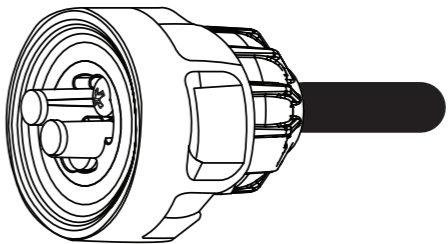

ASSEMBLED VIEW